

Energy consumption can be reduced to 1 / 2 to 1 / 3 from SM series high speed submersible mixer, when using in the reaction tank.

Features

Energy saving

Mixing of the reaction tank is realized with a slight power density of 2 to 4 W / m³.

Energy consumption can be reduced to 1 / 2 to 1 / 3 compared to SM series high speed submersible mixers.

High maintainability

The maintenance cycle is twice as long as the SM series high speed submersible mixer. In addition, it can be easily pulled up with the portable hanger pipe, reducing maintenance costs.

Smooth mixing of biological flocs

A smooth propeller shape and low blade tip speed provide gentle mixing for biological flocs and so on.

Installation on the tank wall side

Unlike other mechanical mixing systems, there is no need for structures (installation structures or inspection walkways) at the center of the tank, so the installation to the existing tank can be reduced the construction period and cost.

Applications

Energy save mixing in denitrification tank and reaction tank.

Standard Specifications

Model	Rated output (kW)	No. of poles	Phase	Synchronous rotation speed (min ⁻¹)	Propeller code	Propeller diameter (mm)	Minimum width (mm)	Power for mixing clear water (kW)	Flow (m ³ /min)	Thrust (N)	Weight (kg)
SMM8	0.75	8	3	109	723	1,100	Approx. 370	0.7	109	600	Approx. 100
SMM15	1.5	6		137	722			1.4	137	1,000	
SMM22	2.2	4		156	721			2.0	156	1,300	

Dimensions

(Unit: mm)

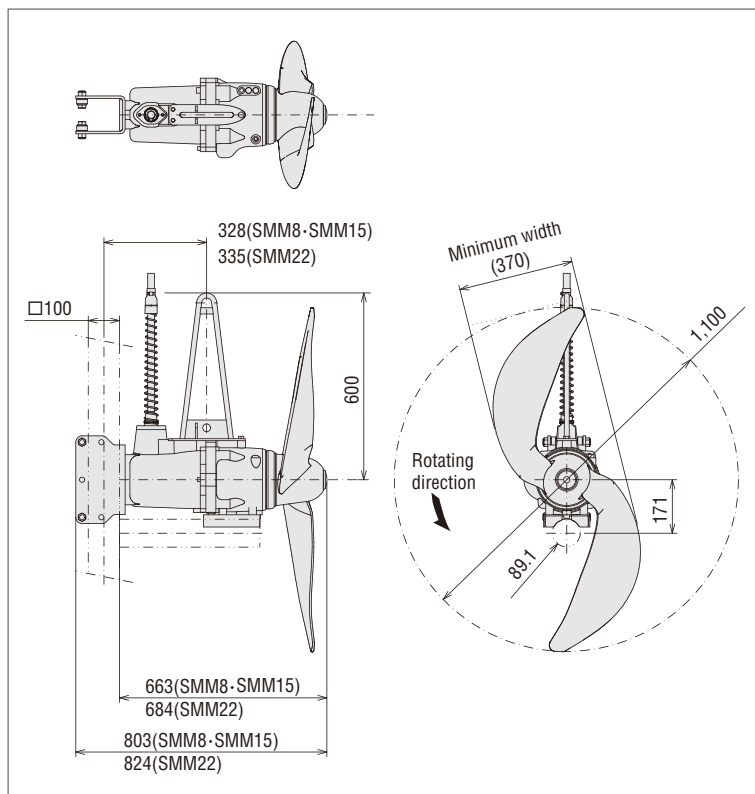

Sectional View

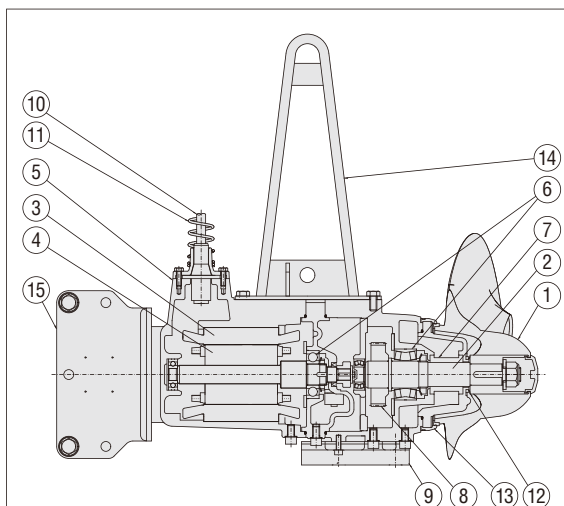

Material

No.	Name	Material	No.	Name	Material
1	Propeller	Glass fiber reinforced plastic (GFRP)	9	Buffer material	Ethylene propylene diene rubber (EPDM)
2	Shaft	316 stainless steel	10	Cable	EPDM insulated PCP sheathed cable with fabric reinforcement
3	Stator	—	11	Support coil	304 stainless steel
4	Rotor	—	12	Oil seal	Acrylonitrile butadiene rubber (NBR)
5	Stator housing	Gray iron casting (FC200)	13	Shield ring	Chloroprene rubber (CR)
6	Bearing	—	14	Hanger bracket	304 stainless steel
7	Mechanical seal	—	15	Sliding bracket	304 stainless steel
8	Gear	Chromium molybdenum steel			